

**START HERE**

***BOSE***

**SOUNDTOUCH<sup>®</sup> SA-5**  
AMPLIFIER



Please read and keep all safety and use instructions. • Læs og opbevar venligst alle sikkerheds- og brugsinstruktioner. • Bitte lesen Sie alle Sicherheitshinweise und Gebrauchsanleitungen durch und bewahren Sie sie auf. • Lees alle veiligheidsinstructies en de gebruiksaanwijzing door en bewaar deze. • Lea y conserve todas las instrucciones de uso y seguridad. • Lue ja säilytä kaikki turvallisuus- ja käyttöohjeet. • Lisez toutes les consignes de sécurité et les instructions d'utilisation, et conservez-les en lieu sûr. • Leggere e conservare tutte le istruzioni per la sicurezza e per l'uso. • Kérjük, olvassa el és tartsa be a biztonsági és használati utasításokat. • Les og ta vare på alle sikkerhets- og bruksinstruksjoner. • Należy zapoznać się ze wszystkimi zaleceniami dotyczącymi bezpieczeństwa oraz instrukcjami użytkowania i zachować je. • Leia e guarde todas as instruções de segurança importantes. • Läs igenom och spara alla anvisningar om säkerhet och användning. • โปรดอ่านและเก็บคำแนะนำด้านความปลอดภัยและการทำงานทั้งหมดไว้ • 모든 안전 및 사용 지침을 읽고 보관하십시오. • 請閱讀並保管好所有安全和使用指示。 • 安全上の留意項目および使用方法をよく読み、それに従ってください。 • يُرجى قراءة كل التعليمات الخاصة بالسلامة والاستخدام والاحتفاظ بها.

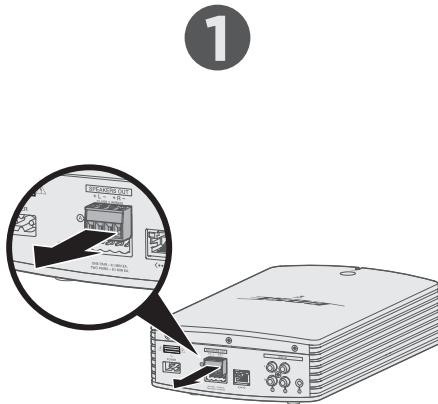

### 1 Remove terminal block A.

Each terminal block accepts one pair of speakers.

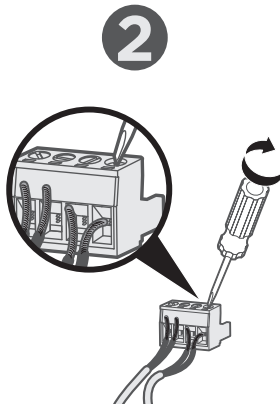

### 2 Connect and secure the speaker wires to terminal block A.

1. Insert the left speaker's marked wire into the **+ L** positive terminal and the plain wire into the **L -** negative terminal.
2. Insert the right speaker's marked wire into the **+ R** positive terminal and the plain wire into the **R -** negative terminal.

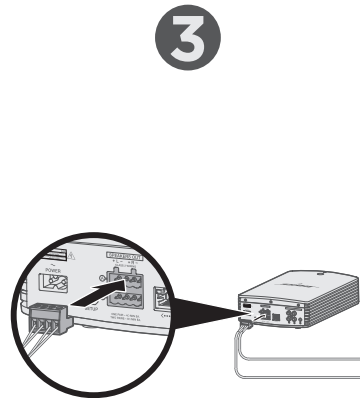

### 3 Reinsert terminal block A.

To connect a second pair of speakers, repeat steps 1-3 using terminal block B.

**Note:** Refer to your speaker owner's guide for instructions on connecting the other end of the speaker wires to the speakers. You can connect up to two pairs of unpowered speakers.

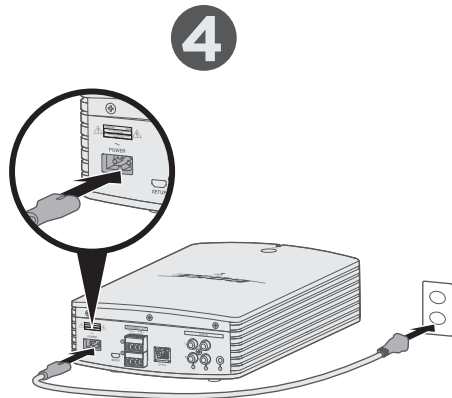

**Connect to power.**

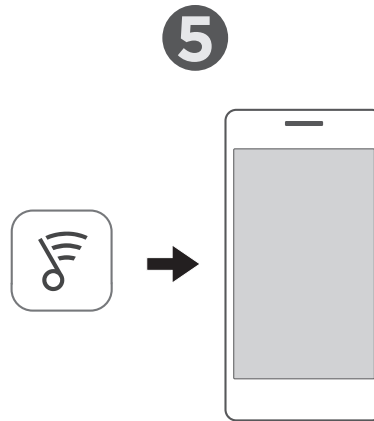

**Download the SoundTouch® app.\***

\*If using a computer, go to [global.Bose.com/Support/SA5](http://global.Bose.com/Support/SA5) to download the app.

---

Have questions? [global.Bose.com/Support/SA5](http://global.Bose.com/Support/SA5)

## Wall-mounting

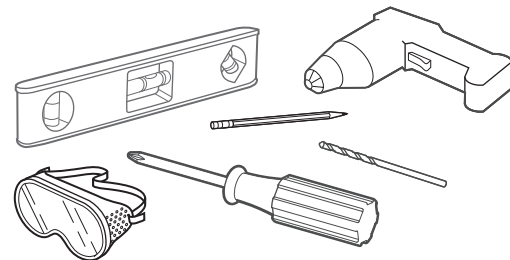
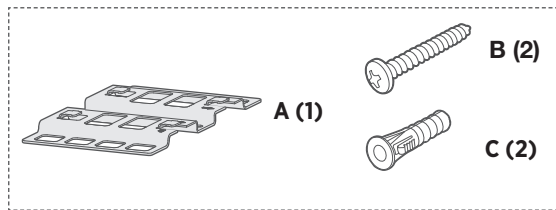

Item	Wood	Wallboard
<b>Wall thickness</b>	$\frac{3}{4}$ in. (19 mm) or thicker	$\frac{3}{8}$ in. (9.5 mm) or thicker
<b>Drill bit</b>	$\frac{3}{32}$ in. (2.38 mm)	$\frac{1}{4}$ in. (6.35 mm)
<b>Phillips-head wood screws (2)</b>	#10 x $1\frac{1}{4}$ in. (M5 x 32 mm)	#10 x $1\frac{1}{4}$ in. (M5 x 32 mm)
<b>Plastic anchors (2)</b>	Not used	#10 (M5) plastic anchors

1

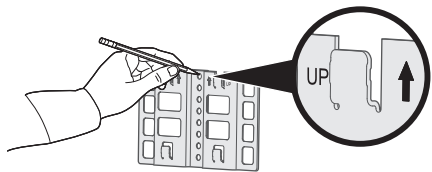

2

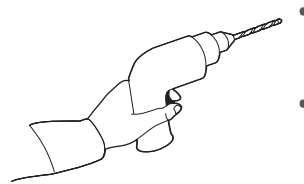

3

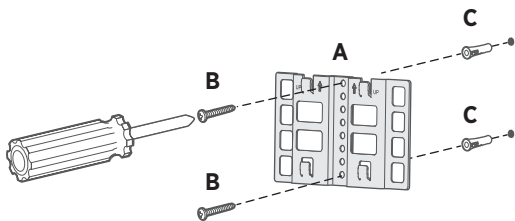

4

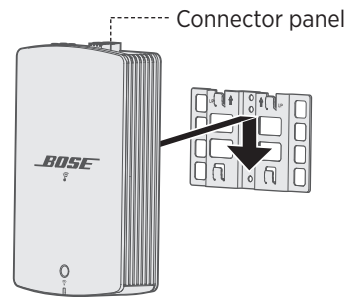



**[global.bose.com/Support/SA5](https://global.bose.com/Support/SA5)**



787178-0010

***BOSE***

©2016 Bose Corporation, The Mountain,  
Framingham, MA 01701-9168 USA  
AM787178 Rev. 00